

Sup. Comm. Garage+Cantina: mq. 31,02

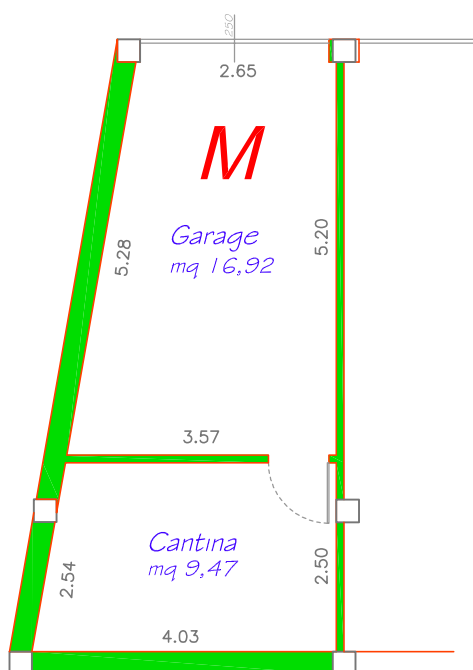

oggetto:
Santarcangelo di Romagna
Residenza "NUOVA CONTEA"
FABBRICATO 1
GARAGE e CANTINA "M"
Piano INTERRATO

Semprini
Severino

Via Casale, 297 scala C int. 2
47827 Villa Verucchio (RN)

Tel. 0541.670472 - Fax 0541.673035
www.immobiliaresemprini.com
info@immobiliaresemprini.com

scala:
1:100